

BUILDING DESIGN PARTNERSHIP SHALL HAVE NO RESPONSIBILITY FOR ANY USE OF THIS DOCUMENT OTHER THAN THAT FOR WHICH IT WAS PREPARED AND ALL DIMENSIONS SHOULD BE CHECKED ON SITE.
DO NOT SCALE FOR CONSTRUCTION PURPOSES.

NOTES

Plan to be read in conjunction with following documents:

Tree survey, Arboricultural Impact Assessment, Arboricultural Method Statement and Tree Protection Plan in accordance with BS5837:2012 prepared by Haydens Arboricultural Consultants

Survey of Schedule 9 Listed Invasive Weed Species prepared by Elcot Environmental

All tree works should adhere to current best practice detailed within BS 5827:2012 (Trees in relation to design, demolition and construction - recommendations)





For removal of existing trees within tree protective fencing areas and/or within Root Protection Areas of other trees, refer to Haydens Arboricultural Consultants' document listed above

The position, condition and dimensions of the trees are based on a site survey undertaken on 12/02/14

The original of this drawing was produced in colour - a monochrome copy should not be relied upon

All existing trees to be removed as approved under Condition Z7.1 for Phase 1A(N) RMA are not shown on this plan. This plan only shows additional trees to be removed within 10 metres of the Phase 1A(S) RMA boundary.

LEGEND

-  Boundary of Claremont Park Road (Part 1) Reserved Matters Application
-  Proposed Boundary of New Claremont Park under Phase 1 North Application
-  Trees and Vegetation to be Retained
-  Trees and Vegetation to be Removed under Phase 1A South Application

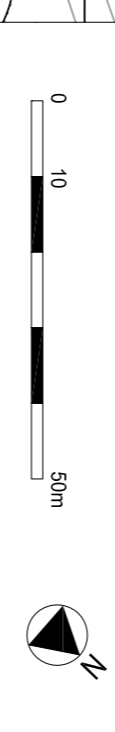

FIRST ISSUE FOR INFORMATION YL MS 22/10/15

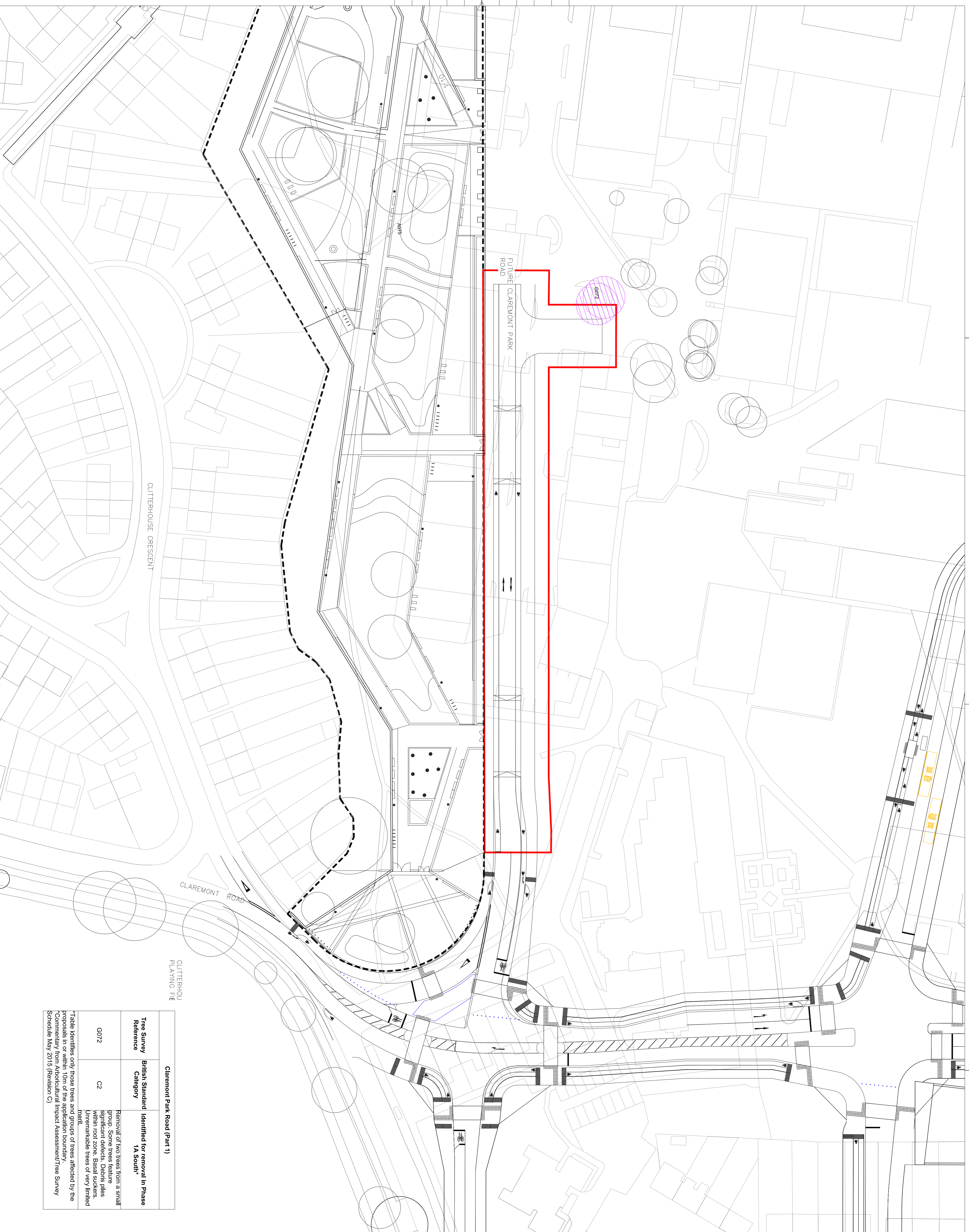

Claremont Park Road (Part 1)	
Tree Survey Reference	British Standard Category
G072	C2
Identified for removal in Phase 1A South Removal of two trees from a small group. Some trees feature significant defects. Debris piles within root zone. Basal suckers. Unremarkable trees of very limited merit.	

Table identifies only those trees and groups of trees affected by the proposals in or within 10m of the application boundary. Commentary from Arboricultural Impact Assessment/Tree Survey Schedule May 2015 (Revision C)



16 Broomhouse Yard
London EC1V 4LJ
United Kingdom
T +44 (0)207 812 8000
F +44 (0)207 812 8399
www.bdp.com

BRENT CROSS PHASE 1A SOUTH

CLAREMONT PARK ROAD (PART 1) TREE REMOVAL PLAN

Project Ref: P2007004
Date: 1:300 @ A1
1:1000 @ A3
22/10/15